

Table 1

Pos 1	Cylinder	Stroke mm	L1 mm	Weight* (app.) kg
362116	149-4	4435	1347	317
362119	149-4	5204	1447	331
362122	149-4	5484	1517	340
362125	149-5	6008	1347	339

* With Pos 23 = 363087
(Side height 1100)

Table 2

Side height mm	Pos 23
900	363085
1000	363086
1100	363087
1200	363088
1300	363089
1400	363090

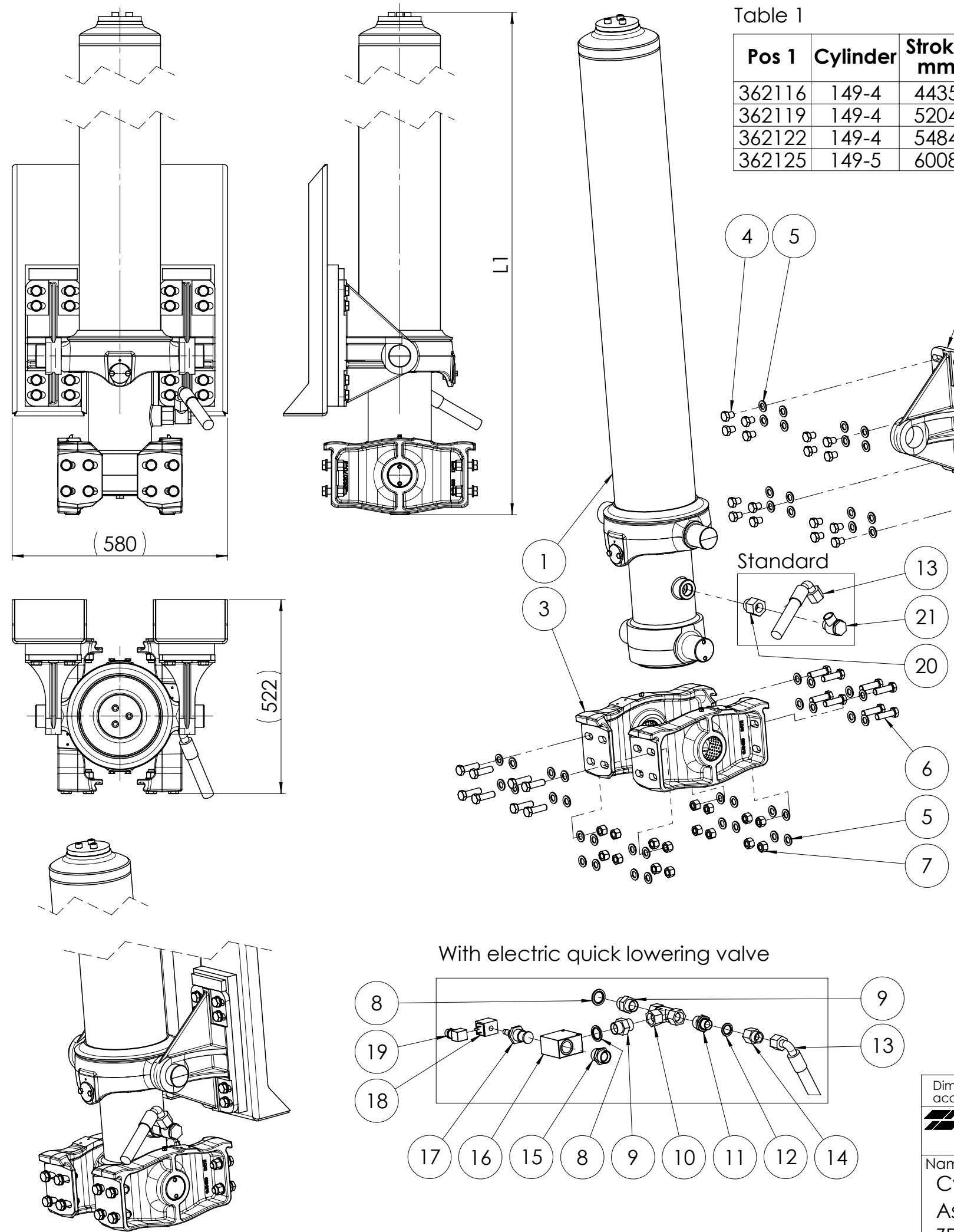

Pos	Ant.	Art.nr	Name	Benämning	Material	Dimension
23	2	Table 2	Profile cyl. attachment	Profil tippinfästning		
22	2	329620	Bracket plate DFC	Fästplatta DFC		
21	1	281394	Swivel Wipro	Svivel Wipro		3/4"
20	1	13368	Nipple	Nippel		IR 3/4" - UR 1"
19	1	265561	Electric connector	Elanslutning magnetventil		
18	1	19116	Solenoid 26V	Magnetspole 26V		
17	1	361657	Cartridge valve 1" NS	Ventilpatron 1" NS		
16	1	361654	Valve housing 1"	Ventilhus 1"		
15	1	994 6594	Ermeto coupling	Ermetokoppling		GE28 - LR
14	1	181784	Coupling S R	Koppling S R		IR 3/4" - 20
13	1	340891	Hydraulic hose 280 bar	Hydraulslang 280 bar		3/4", 1500 mm
12	1	168617	Sealing washer	Tätningbricka		R3/4"
11	1	204859	Nipple	Nippel		UR 3/4" - UR 1"
10	1	360061	T-coupling	T-koppling		1"
9	2	162529	Nipple	Nippel		UR 1" - UR 1"
8	2	193276	Sealing washer	Tätningbricka		R1"
7	16	196527	Locking nut	Mutter lås	FZB	M16
6	16	178806	Screw M6S	Skruv M6S	10.9 FZB	M16 X 55
5	48	175521	Washer	Bricka	FZB	17,0x30x3
4	16	178780	Screw M6S	Skruv M6S	10.9 FZB	M16 x45
3	2	362134	Bearing beam	Lagerbalk		
2	2	356596	Body bracket DFC/ENC	Korgfäste DFC/ENC		
1	1	Table 1	DFC Cylinder	DFC Cylinder		

Dimensions without individual tolerance acc. to SS-ISO 2768-1c

N.B. The copyright and ownership of this drawing including associated computer data are and will remain ours. They must not be copied, used or brought to knowledge of any third party without our prior permission. © Zetterbergs Industri AB, Sweden

ZETTERBERGS	Ritad/Drawn 140430	Godk./Approved RP	Skala/Scale 1:12	Vikt/Weight See table 1
Name Cylinder DFC Assembly ZD4	Benämning Cylinder DFC Montering ZD4		Size A3	Ersätter/Replace Ritn. nr/Drawing no. 363265

Ingår i: